

Des-Case®

DC-13-PI

The DC-13-PI includes a pressure indicator attached to a breather standpipe accessory (DC13). The indicator is a simple device that accurately measures the air induction system filter restriction. It measures and remembers the highest restriction at maximum air flow, which is called full load condition.

The indicator is easy to read. As the air filter plugs, and restriction increases, the single position service indicator window turns red indicating maximum restriction has been reached. The air filter should then be changed and the indicator reset to zero. Reset the indicator by pushing the yellow reset at the end of the indicator.

Breathers typically show low restriction through most of their service life. As the breather filter nears the end of available service life, filter restriction will increase more rapidly, and will move quickly towards the red zone. High humidity or rainy conditions may slightly increase air restriction.

Use of the pressure indicator helps to determine and maximize breather service life, protects the integrity of the breather and related lube systems, and saves on maintenance costs.



MODEL NUMBER	DC-13-PI (1/8" PIPE THREAD)
Operating Temperature:	-40 to +250°F (-40 to 121°C)
Calibration:	6" - 40" H2O (1.5-10kPa) vacuum
Accuracy:	±10% at 15" to 40"
Material:	Polycarbonate housing
Dimensions (len. x dia.)	46.9 mm x 47.5 mm

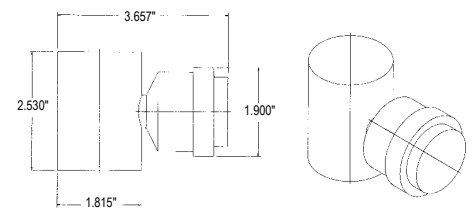

DC-13 standpipe adapter stands 2.5" tall and provides a 1" slipfit to 1" F-NTP design.

Des-Case Technical Support 615.672.8800

® The Des-Case name and logotype are registered trademarks of Des-Case Corporation.
© 2004, Des-Case Corporation, all rights reserved.

DC-13PI0404

Gearboxes

Reservoirs

Transformers

Storage Tanks

