

Des-Case® Laboratory

In the two last years, DESCASE established our internal test laboratory. We produce tests here after describe:

- **Airflow Test:** In this test a breather is attached to a flow meter to measure the air flow and pressure drop through the breather.
- **Vibration Test:** In this test a breather is mounted on a single axis, frequency controlled shaker table. This test is used to determine fatigue limits in a high vibration or mobile equipment application.
- **Adsorptive Life Cycle Test:** The machine used in this test consists of two chambers connected through a breather port. The lower chamber is used to simulate a gearbox, and the top chamber simulates outdoor conditions. The breather is mounted in the upper chamber. The temperature and humidity in the upper chamber can be adjusted to simulate various environmental conditions. Air is cycled between the two chambers through the breather at a rate of 1cfm. Temperature and humidity readings are taken from each chamber and logged through data acquisition software.
- **Impact Resistance Test:** The breather is threaded into the test fixture. Then, it is hit with a 4lb hammer attached to a pendulum. We have videos of this test and the same for other products offered by competitors.

Des-Case® Quality Assurance

To be sure that we supply best products as possible, DESCASE established quality rules here after describe:

- **Failure Mode, Effects, and Criticality Analysis:** FMECA's are part of the development process for all new products. This analysis helps identify and correct potential design flaws before it goes to market.
- **Receiving Inspections:** All Raw Goods are randomly inspected when they are received. Parts that have recurring issues are placed on a “watch list” and remain there until we receive five consecutive shipments without issues.
- **WIP Inspections:** All product lines have specified QA inspections during the assembly process. These are all defined in the Master Control Plan.
- **Finished Goods Inspection:** Finished Goods are randomly inspected as well. The inspector looks for correct package labeling, product count, and does a final breather inspection.

3.3.3 Naßluftfilter nach F 5125 Typ 4

Der Naßluftfilter F 5125 Typ 4 ist für im Intervallbetrieb eingesetzte Getriebe und bei Getrieben, die in sehr hoher Luftfeuchtigkeit (Papierindustrie, Tropen, Küstennähe usw.) betrieben werden, vorzugeben.

Bezeichnungsbeispiel SAP: FILTER-LUFT NASS G1 VA F 5125 TYP 4

Materialkurzbest: F 0360: FILTER-LUFT

Materialklasse: SM_0199

Material-Nr.: 1.158.099

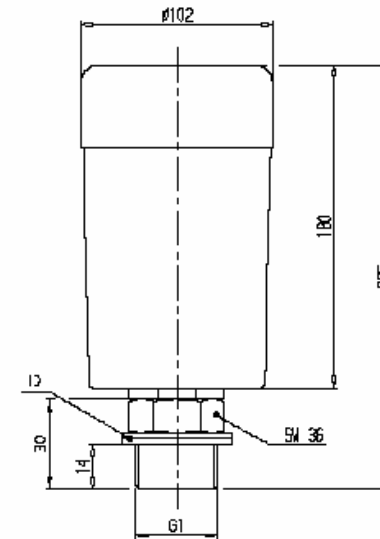

1) Adapter

Bild 5: Naßluftfilter G1 F 5125 Typ 4

Technische Daten

Filtereinheit: 3 µm

Temperaturbeständigkeit: -50 °C bis +120 °C

Werkstoff: Macrolon, Polyethylen und PVC (keine statische Aufladung möglich)

Werkstoff Adapter: Messing

Gewicht: 0,75 kg

Zulässiges Anlagenvolumen (z. B. Getriebe) 1500 l (bei Volumen > 1500 l sind zwei Filter einzusetzen).

Inbetriebnahme:

Vor Inbetriebnahme müssen 2 der 8 Bohrungen (mit Stopfen verschlossen) an der Unterseite des Filters geöffnet werden. Ein Austausch des Filters ist bei kompletter Durchdringung des Filters vorzunehmen.

Des-Case® Flender-Siemens agreement

Des-Case® CMD agreement

Application :

Ces filtres peuvent être utilisés sur des appareils d'un coût élevé, ou installés sur des sites à l'ambiance polluée et humide. Ils offrent une protection efficace contre la pollution de l'huile par la poussière et par l'eau.

Présentation :

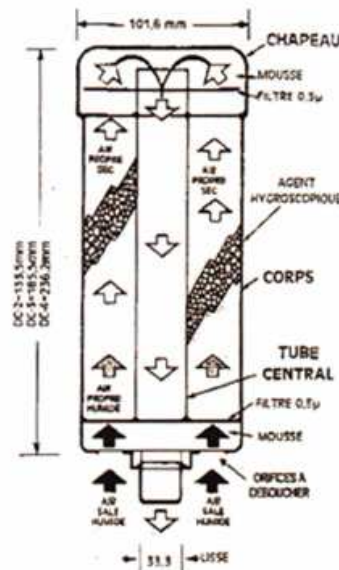

Code article	Type	Débit max	Masse	Volume du carter
		l/min	kg	litres *
FR-DC2	DC2	300	0,53	600
FR-DC3	DC3	450	0,75	2000
FR-DC4	DC4	600	0,98	4000

* volume total du carter, différent de la capacité en huile

Adaptateur DC10 :

(Matière : PVC)

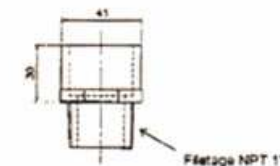

L'adaptateur DC10 se monte par l'intermédiaire d'un taraudage NPT 1" (IT/IPS/VEC/16), ou directement sur les portes de visite VR taraudées 1" gaz (IT/IPS/PRT/02).

Commander un adaptateur avec chaque filtre approvisionné.

Montage :

Cet accessoire se monte en lieu et place du reniflard standard, par l'intermédiaire de l'adaptateur DC10, fileté 1 pouce (voir dessin ci-dessus).

Attention : lors de la mise en service, mettre en fonctionnement le filtre en débouchant le nombre d'orifices indiqués ci-contre (en fonction du type de filtre) :

DC2 : 2 orifices
DC3 : 4 orifices
DC4 : 6 orifices

Entretien :

Le degré d'usure du filtre est indiqué par la coloration de l'élément filtrant :

- Couleur bleue : filtre neuf,
- Couleur rose : filtre saturé en eau, à remplacer.

Date d'émission	Emetteur	Vérificateur	Approbation AQ
16/11/1998	M.BRICOUT	A SANSON	P.RICHEZ



Des-Case® Eickhoff agreement

on:

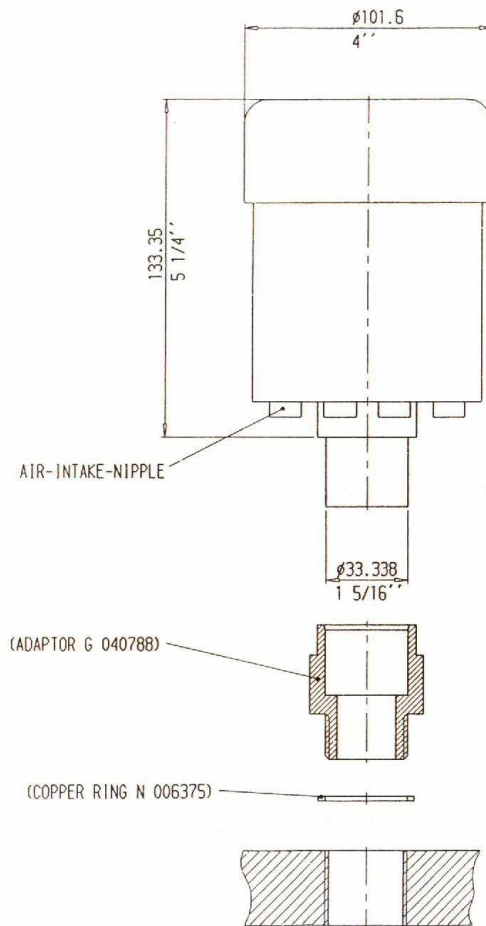



INSTALLATION PROCEDURE

1. Remove closing screw from gearbox
2. Remove air tight cap from 1' Standpipe
3. Cut off air intake nipples
4. Mount threaded adaptor G 040788 using the copper ring N 006375

AIR FLOW THRU BREATHER	OR	LIQUID FLOW IN/OUT OF TANK	NUMBER OF NIPPLES TO OPEN
0-5 CFM		0-35 GPM	2

5. Plastic bag cover can be left on unit when utilized in extremely dirty or outdoor applications.

MANUFACTURER: DES-CASE, USA

Material: Div.	Remark: CH=20	NR: 24.7.96 vcl.	Drawn: 22.07.96 GRYZ
Scale: 1 : 1.5		FEV:	Checked: GRYZ <i>Jgr</i>
 Copyright DIN 34	Designation: HYGROSCOPIC BREATHER		
Weight kg: 0.5	MODEL DC-2	Part No.: (e) G 040789	
Type: BSULG-075	Register word No.: 1954 /		
Enz.-Gr.-Nr.: 343	Replacement for:	Similar No.:	